

# FIDE WORLD SCHOOLS TEAM CHAMPIONSHIP

Washington, D. C., USA, 2-7 August 2025



WORLD  
SCHOOLS TEAM  
CHAMPIONSHIP  
2025



INTERNATIONAL  
SCHOOL CHESS  
FEDERATION

## INVITATION

The International Chess Federation (FIDE) and the International School Chess Federation (ISCF) invite all FIDE member federations and eligible players to participate in the World Schools Team Championship 2025. The competition will be held in Washington, D.C./Alexandria, USA, from 2nd (arrival) to 7 (departure) August 2025. Playing venue is Episcopal High School, located 1200 North Quaker Lane Alexandria, Va 22302, city Washington.



## 1. General

1.1 The World Schools Team Championship (WSTC) is the flagship FIDE and ISCF competition among the teams of general educational institutions shall be governed by the General Regulations for FIDE Competitions (EVE), except where these Regulations override them.

1.2 WSTC is organised under the aegis of the FIDE Events Commission (hereinafter referred to as "EVE").

1.3 Teams of chess academies, chess clubs, chess departments of junior physical training clubs, specialised sports schools, Olympic reserve schools, or those that combine players from more than one general educational institution are not allowed to participate.

1.4 Players born between 2008 and 2017 inclusive are eligible for participation in WSTC 2025 edition. Each team shall include at least two members born in 2012 or later. Special cases may be considered under exceptional circumstances, subject to EVE's approval.

1.5 Each team shall consist of four main players, one reserve and one non-playing captain. All members of the team must have a FIDE ID.

1.6 Where possible, the team shall consist of boys and girls.

1.7 The national federations have to conduct the eligibility checks that the children are educated at the school that is entering the tournament. A team that is found to have an ineligible player will be subject to the following sanctions:

- The team and its individual players will be disqualified from the competition and forfeit all prizes they have won (see Article 4.11).
- The school will be banned from participation in the next edition of the competition. This ban may be extended by FIDE Council.
- The National Federation will be banned from entering teams into the next edition of the competition. This ban may be extended by FIDE Council.
- FIDE Council may report any of the parties involved to the FIDE Ethics & Disciplinary Commission for further investigation, which may lead to further sanctions.

## 2. Schedule

WEEKDAY	DATE	TIME	EVENT
Saturday	2nd August	10:00 - 19:00 21.00*	Arrival, Accreditation Technical meeting
Sunday	3rd August	10:00 - 10:30	Opening Ceremony
Sunday	3rd August	11:30 - 13:30	Round 1
Sunday	3rd August	15:00 - 17:00	Round 2
Monday	4th August	11:00 - 13:00	Round 3
Monday	4th August	15:00 - 17:00	Round 4
Tuesday	5th August	11:00 - 13:00	Round 5
Tuesday	5th August	15:00 - 17:00	Round 6
Wednesday	6th August	10:00 - 12:00	Round 7
Wednesday	6th August	13:30 - 15:30	Round 8
Wednesday	6th August	20:30	Closing Ceremony
Thursday	7th August		Departure

\* Time of the Technical meeting to be confirmed. Please follow the official website [worldschoolteam2025.fide.com](https://worldschoolteam2025.fide.com)

### 3. Registration

- 3.1 The deadline for the registration is 1st of July 2025.
- 3.2 In order to ensure proper tournament standards, FIDE member federations must fully complete the official online registration, accommodation & travel form before 1st July 2025 including information about the national schools team competitions with dates and relative links. Those FIDE member federations, who will have national championships later than 1st of July or another exclusive circumstance, do not need USA visa and have informed the Organizers in advance via the official online registration form, will be able to submit the final list of the delegation after the Orgcommitte approval and not later than 10th July. This exception applies if there are available spots as per p. 5.1.
- 3.3 Incomplete registrations will not be accepted. Individual applications will not be accepted also.
- 3.4 The registration form is available via link:  
<https://worldschoolteam2025.fide.com/registration2025/>  
There will be an option to submit passport data for visa application.

### 4. Tournament format

- 4.1 The tournament will be an 8-round Swiss, played with two games per day over 4 days.
- 4.2 The captain will provide their four main players and reserve in a fixed board order not later than the end of technical meeting. This order will be fixed for the duration of the tournament. There is no requirement to assign board numbers in rating order.
- 4.3 The team composition for each round shall be submitted not later than 30 minutes before each round. A team captain who fails to submit their team composition in a round will be deemed to have chosen the four main players in their team.
- 4.4 The first-named team in a pairing shall have the white pieces on the odd-numbered boards, the black pieces on the even-numbered boards.
- 4.5 The time control will be 45 minutes, plus 10 seconds increment per move starting from move one.
- 4.6 The default time is 10 minutes.
- 4.7 The following FIDE regulations apply in full (see Annex 1):
- 4.7.1 Captains and Heads of Delegation
- 4.7.2 Appeals Committee Procedural Rules; the appeal fee will be 200 Euros.
- 4.8 Articles 3-11 of the Olympiad Pairing Rules (see Annex 1) will apply, except that:

4.8.1 Odd Number of Participating Teams (Article 2); this does not apply, and is replaced with, “If there is an odd number of participating teams in a section, the organising federation has the right to enter another team into that section. If this team is paired and plays round 1, it shall remain in the tournament to the conclusion even if teams joining or withdrawing during the tournament results in there being an odd number of teams.”

4.8.2 Ranking of Teams for Pairing Purposes (Article 3); for the purpose of this Article, players without a FIDE rapid rating will instead use their FIDE standard rating. Players with neither of these ratings shall be considered as having a rating of 1000.

4.8.3 Unpaired Teams (Article 10); Article 10.2 shall be “Any paired team that has less than three players for two rounds, consecutive or otherwise, will not be paired for the rest of the tournament.”

4.8.4 Miscellaneous (Article 11); references to the “Global Strategy Commission” shall be to the “Events Commission”.

4.9 “Standard Level” Fair Play Protection Measures will apply (see Annex 1).

4.10 The team rankings will be determined by:

4.10.1 Matchpoints (2 for a match win, 1 for a match draw, 0 for a match loss)

4.10.2 Olympiad Sonneborn-Berger Tie-Break (Chennai)

4.10.3 Gamepoints

4.10.4 Sum of Adjusted Opponents Matchpoints (Chennai)

4.11 The individual rankings for each board will be determined by:

4.11.1 Gamepoint Percentage (forfeit wins and forfeit losses count)

4.11.2 Number of Games Played (forfeit wins count, forfeit losses do not count)

4.11.3 Number of Games Won (forfeit wins count)

4.11.4 Buchholz (rounds where a player is not named to play are ignored; forfeit wins and forfeit losses count as if they were played games)

4.11.5 Higher team ranking (see Article 3.10)

4.12 The following prizes will be presented:

4.12.1 Participation certificates to all players, reserves and captains

4.12.2 All players, the reserve and captain of the first, second and third-placed teams determined by Article 4.10 will receive cups, and gold, silver and bronze medals respectively, and other memorable gifts.

4.12.3 The first, second and third-placed players on each board determined by Article 4.11 will receive gold, silver and bronze medals and certificates respectively. Players must play a minimum of 6 games to be eligible for a board prize. The definition of a played game in 4.11.2 applies.

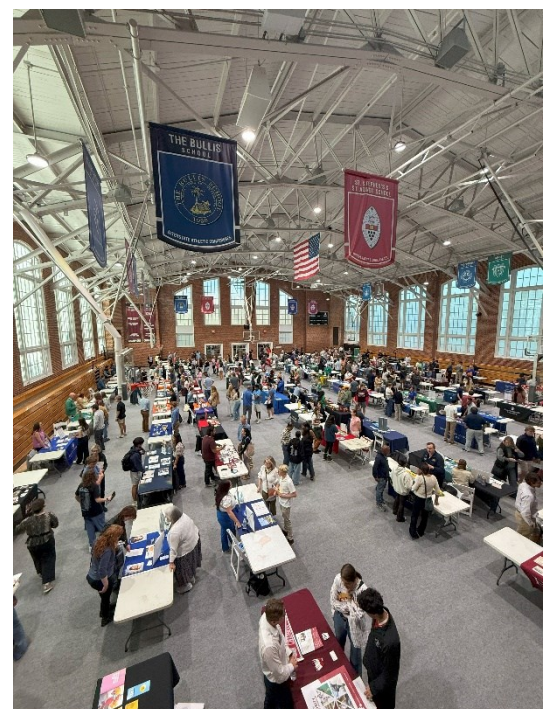



## 5. Participation

5.1 There is a limited number of participating teams, as follows:

- a) 7 teams nominated by FIDE Events Commission.
- b) First 45 teams registered by national federations in a full compliance with the current Regulations. The priority will be given to national federations who hold the national schools team competitions.
- c) 5 teams invited by the ISCF.
- d) 3 teams nominated by the host federation.

5.2 Following the organizers' proposal submitted before the start of the championship, FIDE Events Commission may accept other additional teams to attend the event.

5.3 The participating teams shall be responsible for their own travel expenses, insurance, and other matters not covered in Articles 6.3.1 – 6.4. The National Federation is allowed to assume this responsibility from the participating teams.

5.4 The players and the captains shall strictly abide by all internal rules and regulations of both the tournament venue and the official accommodation facilities.

## 6. Accommodation, air tickets and others services

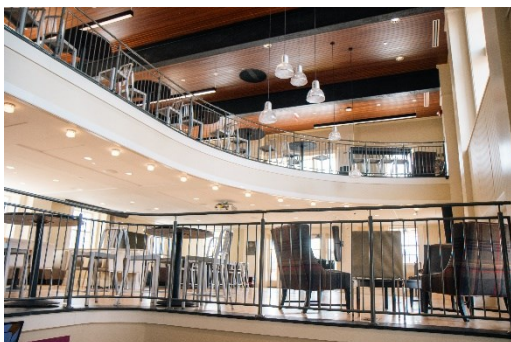

6.1 The accommodation reservation will be done on the "First Come, First Served" basis

6.2 FIDE will be responsible for the global promotion of the competition and travel grants for the teams nominated by FIDE.

6.3 ISCF with the support of the local organizers will be responsible for providing:

6.3.1 Full board accommodation to each team nominated according to 5.1 in two twin rooms and one single room for the children, and one single room for the captain will be provided for the majority delegations in on-campus housing facilities at Episcopal High School. This will be from the arrival day till the departure day. Teams may require additional rooms, and if available, such rooms will be provided at the official hotel at the expense of the team or National Federation to be paid directly to the hotel. If on-campus accommodation is not available due to capacity limitations, teams will be accommodated in a hotel of 4-star standard with the same room allocation.

6.3.2 Accompanying persons and non-nominated teams are invited to stay at the official hotel –

Hilton Alexandria Mark Center (5000 Seminary Road, Alexandria, VA, US, 22311) – at their own expense.

[https://www.hilton.com/en/hotels/dcaahhf-hilton-alexandria-mark-center/?SEO\\_id=GMB-AMER-HH-DCAAHHF&y\\_source=1\\_MTIyMDkxNi03MTUtbG9jYXRpb24ud2Vic2l0ZQ%3D%3D](https://www.hilton.com/en/hotels/dcaahhf-hilton-alexandria-mark-center/?SEO_id=GMB-AMER-HH-DCAAHHF&y_source=1_MTIyMDkxNi03MTUtbG9jYXRpb24ud2Vic2l0ZQ%3D%3D)

Room Rates (breakfast included):

- Single rooms: \$159 plus applicable state and occupancy taxes, currently 15.50% and \$1.25 (subject to change)
- Double rooms: \$179 plus applicable state and occupancy taxes, currently 15.50% and \$1.25 (subject to change)

6.3.3 Full board accommodation and stipends of tournament officials. The officials will be one Chief Arbiter, two Deputy Chief Arbiters, one Pairing Officer, one Fair Play Officer, one FIDE Technical Delegate, three members of Appeals Committee and an appropriate number of Match Arbiters.

6.3.4 Transfers to and from the airport and local transportation, free of charge for all participants.

6.3.5 The Venue

6.3.6 Opening and Closing ceremonies

6.3.7 Refreshments in the playing venue

6.3.8 Volunteers

6.3.9 Local promotion

6.4.10 Additional cultural program, museum visits and excursions

6.4 All 60 teams mentioned in point 5.1 are entitled to free accommodation – two twin rooms, two single rooms.

## **6.5 Buying the tickets for the teams covering:**

- Economy class flights from the member Federation to the host city.
- Any domestic internal travel expenses from the city in which the school is situated to the airport (e.g. standard class rail fare, internal flights).

6.5.1 The Organizers will purchase flight tickets directly, once the team's participation has been officially confirmed via email. The Organizers may also assist in booking tickets for accompanying persons, provided that the full cost of such tickets is covered by the accompanying individuals themselves.

6.6 All participants will be provided with transport services on 2<sup>nd</sup> August as well as the departure transfer on 7<sup>th</sup> August. If any delegation arrives one or two days before the competition or leaves later the same service will not be provided.

6.7 Delegations who make private transport arrangements and clearly indicate this in the registration form will be fully responsible for any problems they experience during arrival or departure.

## 7. Players and Captains Conduct

7.1 Each team shall wear a team uniform. The uniform can be created by a National Federation or a team.

7.2 No players with inappropriate cloth (e.g. dirty, ripped) shall be allowed in the playing area.

7.2 The players and the captains are invited to attend all official functions approved by EVE during the WSTC including the Technical Meeting, Opening and the Closing Ceremonies.

7.3 The players are expected to cooperate with the media.

7.4 By participating in the tournament, all players (and their legal representatives, in the case of minors) acknowledge and agree that the Organizers have the right to photograph, record, and livestream the event, including all participants, accompanying persons and others without the need for any additional consent or compensation. The resulting photos, videos, and other media materials may be used by the Organizers for promotional, educational, informational, or any other purposes across all media platforms (including print, digital, and social media), both during and after the tournament without any restrictions.

7.5 By registering a non-playing captain or any accompanying person, national chess federations confirm that these individuals are suitable and eligible to perform their roles at the World Schools Team Championship (WSTC). Each Federation bears full responsibility for ensuring that all such individuals have successfully passed an appropriate background check, in accordance with the legal and safeguarding standards of their respective countries.

The Organizers reserve the right to deny accreditation or access to the event to any accompanying person or non-playing captain if credible concerns regarding their eligibility or background arise.

## 8. Visa information

8.1 Those who need visa must submit their data via online registration system the latest July 1, 2025 to get the invitation letter.

8.2 The Organizers will provide visa support in the form of official invitation letters primarily for the registered participants and, where possible, for accompanying persons. However, the responsibility for arranging visa appointments with the embassies, obtaining entry visas to the host country, as well as any necessary transit visas, lies with the respective national federations and participating teams

8.3 Useful information on visa is here: <https://www.state.gov/visas/>

8.4 The Organizers will issue invitations only after FIDE confirms teams' participation.

## 9. Contact information

Official email [worldschoolteam@fide.com](mailto:worldschoolteam@fide.com)

Official website [worldschoolteam2025.fide.com](https://worldschoolteam2025.fide.com)

## Annex 1 – FIDE Regulations

Relevant FIDE Regulations can be found here:

General Regulations for FIDE Competitions (EVE):

<https://handbook.fide.com/chapter/D0401202312>

FIDE Laws of Chess:

<https://handbook.fide.com/chapter/E012023>

Olympiad Pairing Rules:

<https://handbook.fide.com/chapter/OlympiadPairingRules2022>

Captains and Heads of Delegation:

<https://handbook.fide.com/chapter/CaptainsHeadsDelegation>

Appeals Committee Procedural Rules:

<https://handbook.fide.com/chapter/AppealsCommitteeProceduralRules>

Fair Play Protection Measures:

[https://handbook.fide.com/files/handbook/FPL\\_Protection\\_Measures\\_2024.pdf](https://handbook.fide.com/files/handbook/FPL_Protection_Measures_2024.pdf)

Regulations for the Appointment of Arbiters in World Events:

<https://handbook.fide.com/chapter/B0604082023>

Arbiters Stipend Regulations:

<https://handbook.fide.com/chapter/ArbiterStipendRegulations2024>